

ELECWISH®

Bar Chair



www.elecwish.com

Assembly Instruction

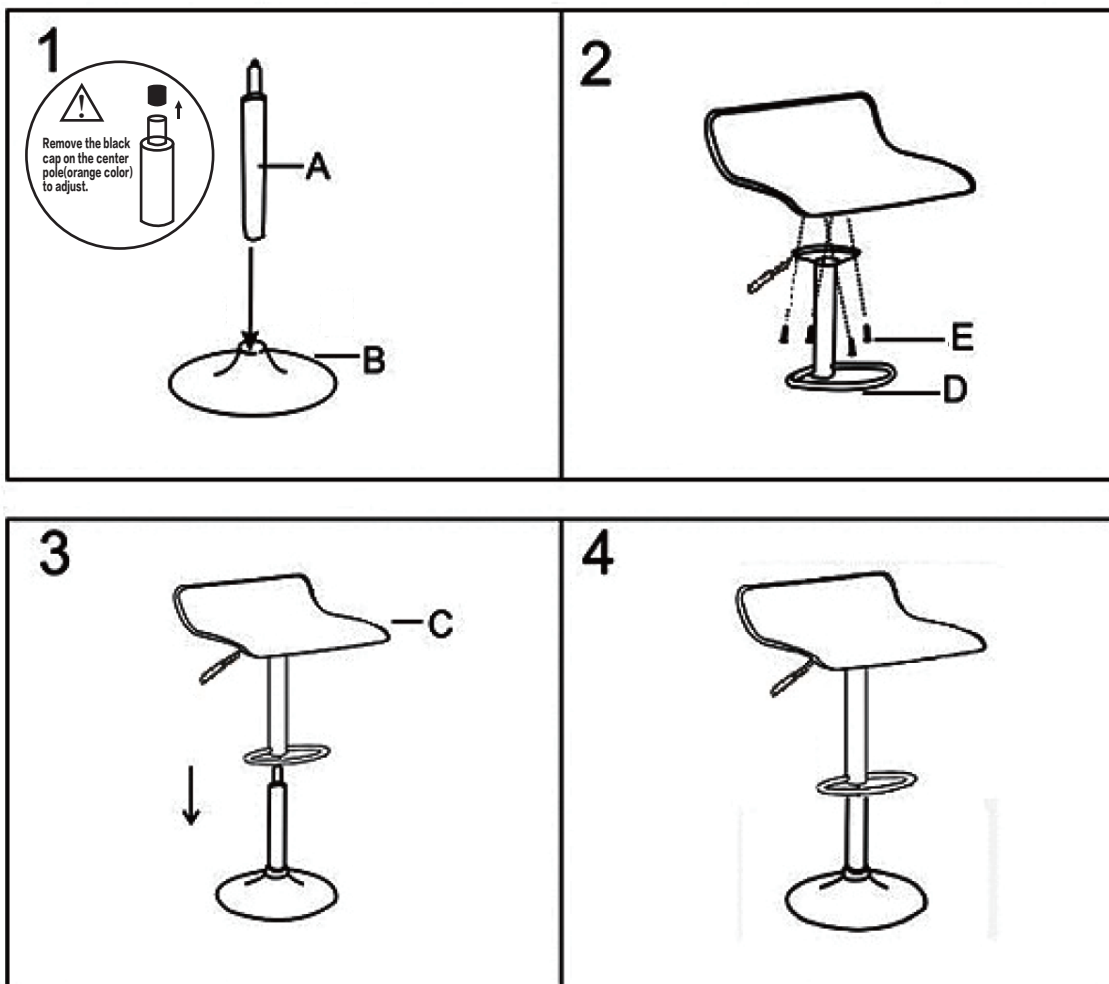

WARNING

1. Do not stand on the stool.
 2. Maximun capacity 364 lbs.
 3. barstool is intended for INDOOR USE.
 4. Keep the leather clear and coated with Corrosion Protection Wax if possible.
- Please remove the black cap on the center pole (orange color) and adjust the silver handle aiming to the orange pole.